

# PARTS AND SERVICE MANUAL

## ELECTRIC

# MAGNUM '1000-E'

# DEHIDER

33 LB'S  
COMP.  
HAND PC.  
+  
CABLE  
0.5 LB'S.

INSTALLATION  
OPERATING

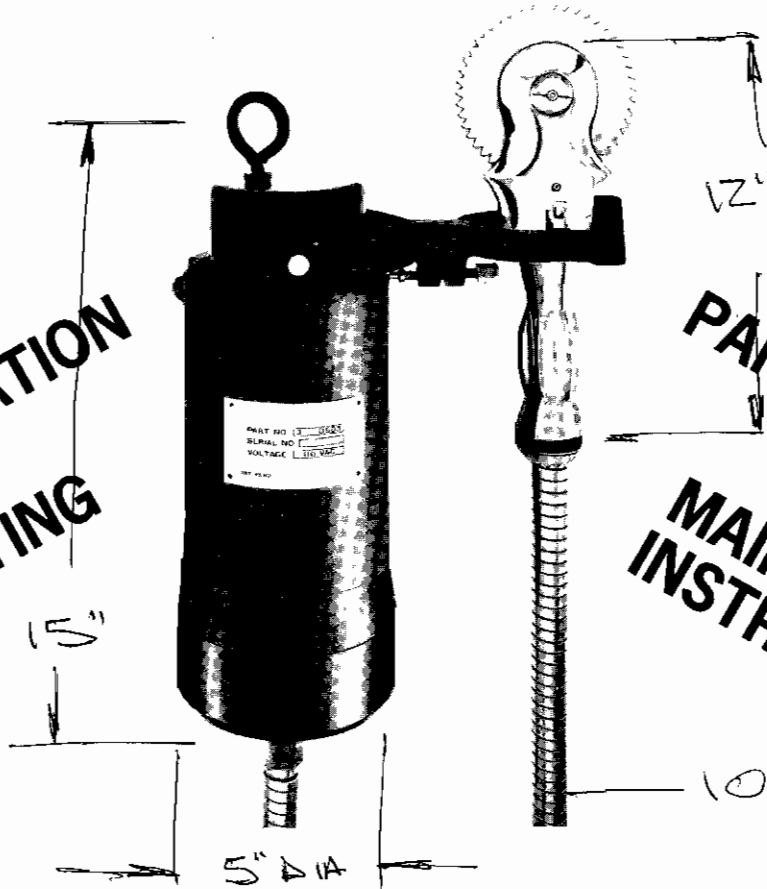

5570 CREEK ROAD • CINCINNATI, OHIO 45242  
Area Code 513 • Phone 791-9180 • Telex 214308 WEPCO

## WARNING

ALWAYS EXERCISE CARE WHEN OPERATING OR PERFORMING MAINTENANCE, REPAIRS AND ADJUSTMENTS. Always disconnect the electrical connector before attempting to work on this tool. Be sure all electrical tools are properly grounded. Never allow any part of your person to be in the path of the knives when tool is in service.

### IMPORTANT

INSPECT YOUR B & D MAGNUM '1000-E' DEHIDER FOR POSSIBLE DAMAGE AS SOON AS YOU RECEIVE IT. IF YOU DISCOVER ANY DAMAGE, NOTIFY CARRIER'S AGENT AT ONCE AND REQUEST HIM TO INSPECT THE DAMAGE. ALSO NOTIFY BEST & DONOVAN. ALSO CHECK THE PACKING LIST AGAINST THE CONTENTS TO BE SURE YOU HAVE ALL PARTS. IF NO DAMAGE IS FOUND, PLACE THE '1000-E' ON A TABLE OR BENCH FOR CONNECTION, LUBRICATION AND TEST OPERATION BEFORE PLACING INTO SERVICE ON THE KILL FLOOR.

## INSTALLATION

The B & D Electric Model '1000-E' Dehider is hung from eyebolt #6371400 at a height and location convenient to the butcher. Equipment is designed to operate on 110 Volts alternating current only and may be connected to a standard outlet. Most safety codes require electrical equipment to be grounded. The '1000-E' is equipped with a ground wire connected to the rounded prong on the plug. If the wall outlet does not have a three-prong socket, use adapter supplied and connect external ground wire from adapter to a screw on the outlet box. The green wire in the electrical system is the ground wire.

If greater flexibility in the flexible shaft is required, the chrome-plated protection spring at the handpiece end of the shaft may be removed. If this spring is removed, care must be taken to avoid tight bends in the shaft.

### IMPORTANT NOTE

- A — USE ONLY B & D No. 21111000 BEARING GREASE. NEVER USE GRAPHITE OR WHITE GREASE. B & D GREASE IS APPROVED BY THE U.S.D.A. IT WILL NOT EMULSIFY OR MELT OUT IN THE STERILIZERS. EXPERIENCE HAS PROVEN IT TO BE THE BEST.
- B — DO NOT OVERTIGHTEN #6361300 ALIGNMENT STUD.
- C — USE ONLY SERIAL-NUMBERED MATCHED PAIRS OF BLADES TOGETHER.

## LUBRICATION

Weekly pull out flexible shaft from housing, wipe clean with a cloth and apply a thick coating of grease #2111100. Insert flexible shaft in housing starting at motor end.

At the middle of a working day, the two grease zerks #6361200 should be greased until grease purges from the body and cap cavities. The electric motor gear housing should be greased once per week with 1-2 shots of grease.

# PARTS LIST — *BEST & DONOVAN*™ MAGNUM '10

## HEAD ASSEMBLY

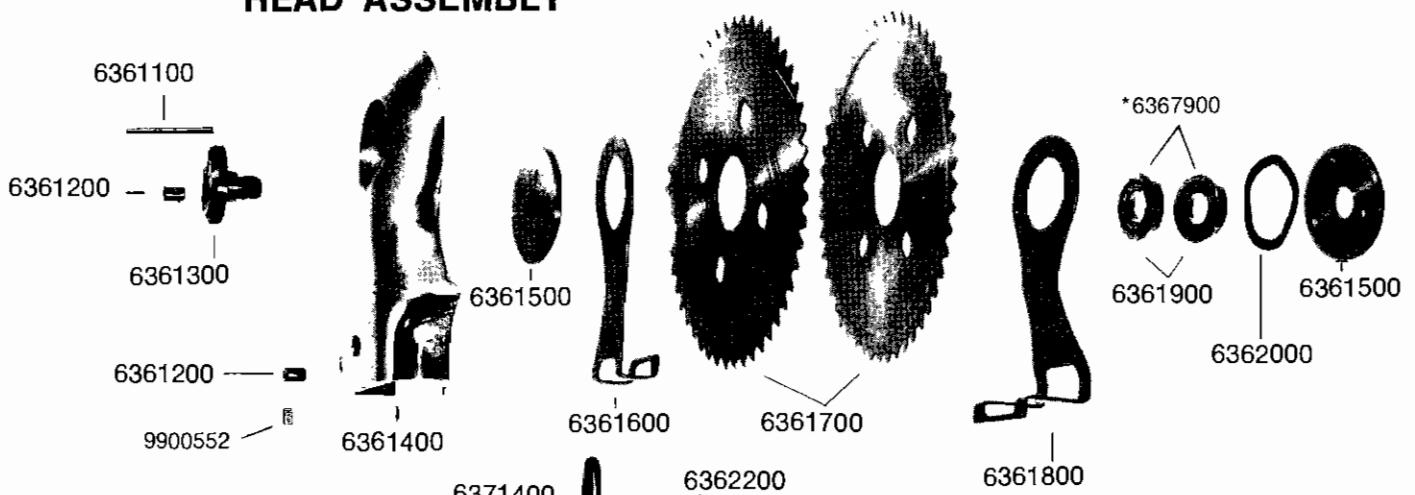

## MOTOR

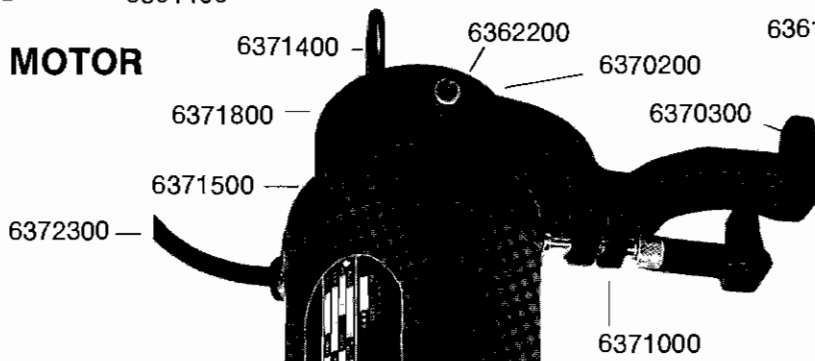

## BELL HOUSING

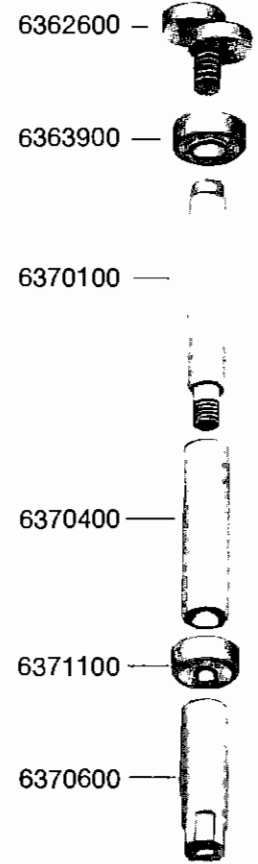
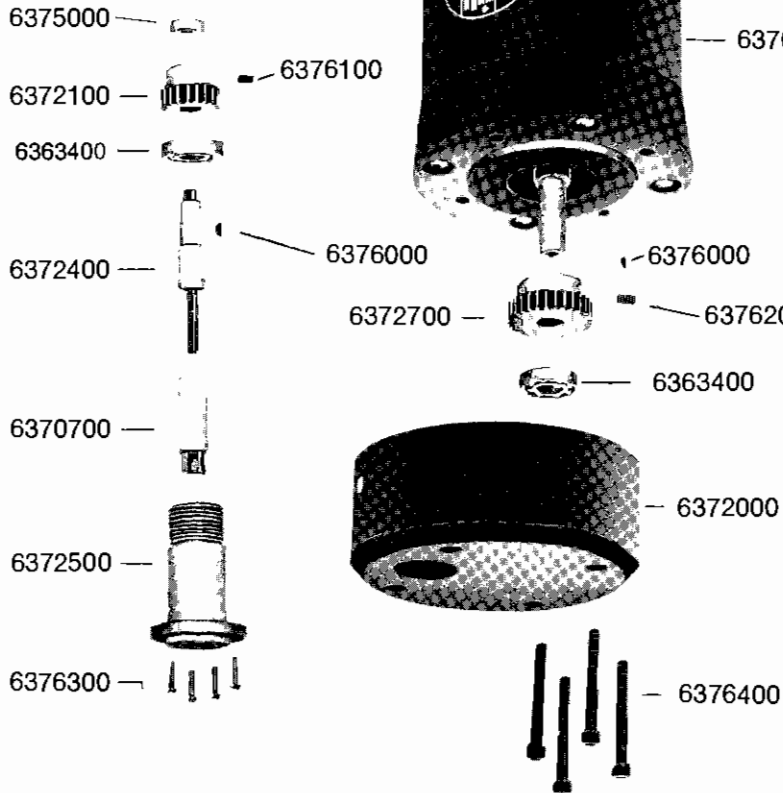

# 1000-E' ELECTRIC DEHIDER

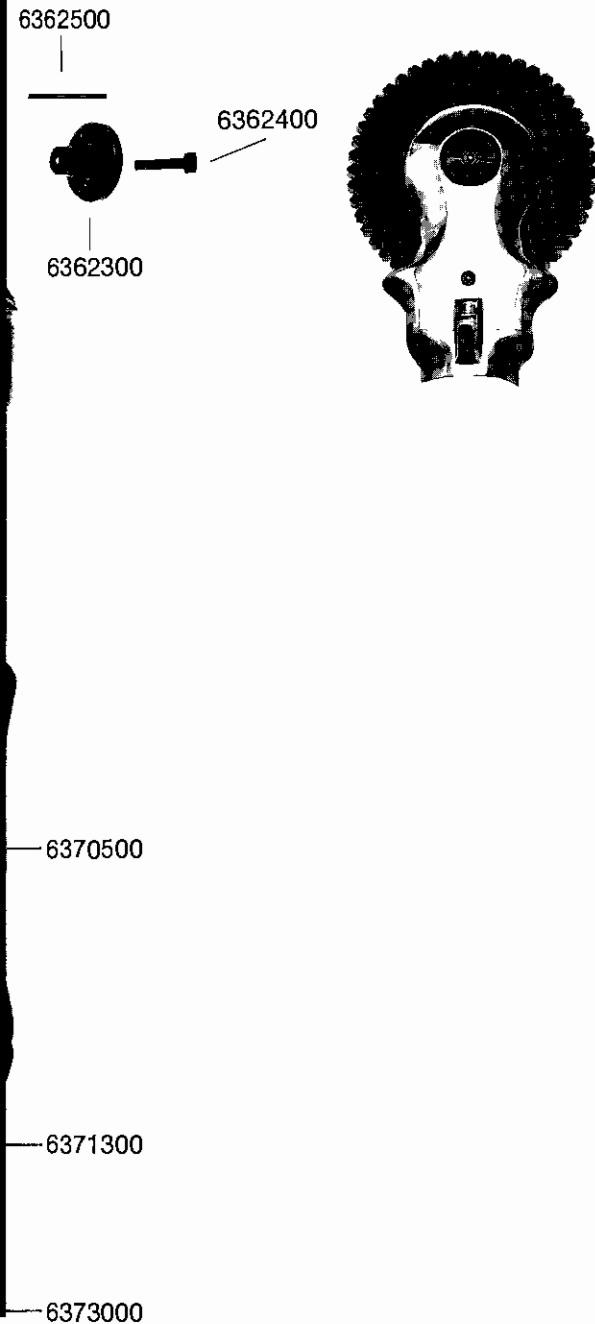

## PARTS LIST

PRIME PART NUMBER	DESCRIPTION
6361100	Rivet — Short Cap
6361200	Grease Valve
6361300	Alignment Stud
6361400	Cap
6361500	End Bushing (2 Required)
6361600	Yoke, Short
6361700	Blades (Pair)
6361800	Yoke, Long
6361900	Ball Bearing (2 Required)
6362000	Spring — Blades
6362100	Body
6362200	Set Screw
6362300	Bearing Shaft
6362400	Allen Socket Screw
6362500	Rivet, Long Body
6362600	Eccentric
6363400	Ball Bearing (2 Required)
6363900	Ball Bearing — Front
*6367900	Steel Bushing (2 req.) [Replaces 6361900 Bearings on some units]
6370000	Complete Electric Magnum '1000-E' Dehider
6370100	Shaft — Drive
6370200	Shaft — Arm
6370300	Arm — Switch
6370400	Spacer — Ball Bearing
6370500	Handle
6370600	Coupling — Head
6370700	Coupling — Motor
6370800	Motor
6371000	Lock Pin Assy
6371100	Ball Bearing — Rear
6371200	Spring — Switch
6371300	Spring — Catch
6371400	Eyebolt
6371500	End Shield
6371600	Strain Relief (Not Shown)
6371700	Switch (Not Shown)
6371800	Cover — Switch
6371900	Plate — Switch
6372000	Gear Housing
6372100	Small Gear Drive
6372300	Cord Set
6372400	Small Gear Drive Shaft
6372500	Flex Shaft Drive Housing
6372700	Large Drive Gear
6373000	Flexible Shaft Assy
6373100	Flexible Shaft Casing
6373200	Flexible Shaft Core
6375000	Ball Bearing
6376000	Woodruff Key
6376100	Set Screw
6376200	Set Screw
6376300	Round Head Screw (4 Required)
6376400	Allen Cap Screw (4 Required)
9900552	Fillister Head Screw

## B & D PACKERS GREASE

1 LB. CAN ----- #2111100

8 LB. CAN ----- #2111200

ESPECIALLY FORMULATED FOR PACKING HOUSE USE. B & D PACKERS GREASE WON'T MELT OUT, WON'T EMULSIFY IN HOT WATER; HAS HIGH LUBRICITY. IT JUST STAYS THERE AND DOES THE JOB. IDEAL FOR DEHIDERS, SAWS, ALL BEARING SURFACES AND HIGH SPEED EQUIPMENT. RECOMMENDED FOR ALL PACKING HOUSE TOOLS AND PRODUCTION MACHINERY.

U.S.D.A. APPROVED

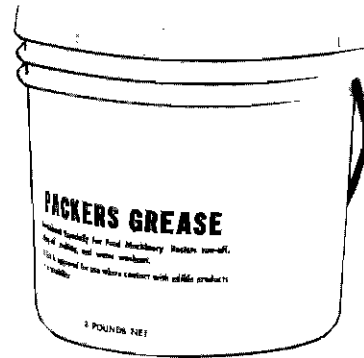

## B & D UNIVERSAL BLADE GRINDER

- Requires no special skill.
- Produces perfectly ground blades.
- Precision index centers each tooth perfectly, eliminates operator error.
- Fast—2 blades may be reground in under (5) minutes.
- Only one grinding operation necessary for gullets, edges and tips.
- Rugged construction.
- American made. You are assured of factory service and parts.

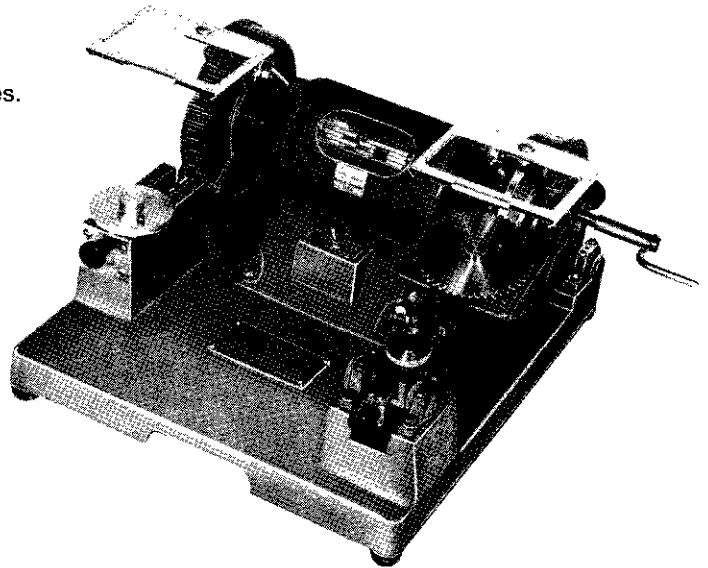
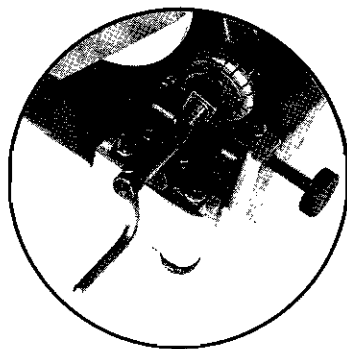

5570 CREEK ROAD, CINCINNATI, OHIO 45242, U.S.A.  
PHONE: Area Code 513 791-9180 Telex — 214308 WEP CO

## **MAINTENANCE**

Preventative maintenance is the first step of good maintenance. A periodic check should be made to replace worn parts and to inspect lubrication levels. A worn part replaced in time may save extensive repairs later.

THIS IS A PRECISION MACHINE made up of precision parts and should be handled with extreme care. Do not squeeze machine or parts in holding device or otherwise misuse. Too much pressure exerted in holding device may cause distortion of part. Be sure you have the correct tools and fixtures before assembling (or disassembling) this machine. When assembling (or disassembling) parts which have a press fit, apply pressure evenly to the parts. To assemble (or disassemble) bearings, the pressure should be applied to the face of the inner or outer race, whichever is adjacent to the mating part. If this is not done, it will brinell the bearing races making it necessary to replace them.

OPEN BEARINGS may be washed in only fresh, clean solvent. Bearings should be washed in a container with a screened false bottom to prevent settlings from being stirred up. After washing, blow solvent out of bearing with a dry, clean air and repack with good grade bearing grease. Do not spin bearing, or allow it to spin when blowing off solvent. Do not attempt to wash a sealed or shielded bearing.

BEFORE DISASSEMBLING a machine, the area around the work bench should be clean and free from metal chips and other foreign matter. It is a good practice to spread a clean cloth on the work bench to prevent the loss of small parts.

IT IS IMPORTANT that all parts are thoroughly cleaned and inspected before assembling. The slightest particles of dirt can ultimately damage this tool.

### **CLEANING THE HANDPIECE**

Keeping the handpiece clean will eliminate unnecessary wear and resulting breakdowns. For sanitary reasons, rinse the handpiece in hot water between each carcass, or whenever tissue accumulates on the blades. Submerge in water only to the center of the blades.

DAILY: Disassemble the handpiece for cleaning and greasing at the end of each workday. This will take no longer than five (5) minutes.

- I. Remove handpiece from flexible shaft by lifting up lock pin #6371300 and pulling handpiece free.
- II. Remove screw #9900552 from the alignment boss. Remove allen screw from #6362300 bearing shaft. Unscrew #6361300 alignment stud. Remove yokes, blades, and blade spring.
- III. Clean interior of body and all parts with solvent and dry carefully.
- IV. Pack grease in body, cap and between blades.
- V. Blades come in serial numbered matched pairs. Install sharp blades with numbers matched between blades. When the blades become dull in this position, rotate 180° to get full use of sharpened blades.
- VI. Reassemble in reverse order. Be sure that alignment stud #6361300 is only thumb tight. DO NOT OVERTIGHTEN.

### **ADJUSTING ELECTRICAL SWITCH**

If automatic cut off switch, connected to switch arm #6370300 fails to shut off motor, when handpiece is hung up, it may be easily adjusted by loosening set screws #6362200 and rotating arm shaft #6370200 with screw driver until switch clicks off. Tighten set screws and adjustment is complete.